



MUSEUM OF THE BAVARIAN KINGS

english

Museum of the Bavarian Kings

Nestled below Hohenschwangau Castle, on the shores of the Alpsee with a view of Neuschwanstein Castle – this was where, long ago, the guests of the royal hunting parties would stay. The former hotel has now been reopened as the Museum of the Bavarian Kings, complete with museum café and restaurant. The exhibition recounts the story of the royal palaces, the people who had them built, and the House of Wittelsbach from its beginnings until the present day, thus providing the perfect addition to any visit to the two royal palaces.



1. Museum foyer
2. Statuette of Maximilian II on horseback, Karl Riederer, 1862, Bavarian National Museum Munich
3. King Ludwig II as a Roman emperor, Caspar von Zumbusch, marble, 1864
4. Pocket watch from Ludwig II for the singer Heinrich Vogl, Lange & Söhne, gold, turquoise, brilliants, lapis lazuli, ca. 1878
5. Sepiolite ('sea foam') pipe which belonged to Maximilian II, horn, ca. 1850
6. Grail chalice crowned by the Patrona Bavariae, gilt bronze, 1906
7. Elaborate chest for the "King Ludwig Album", Peter Herwegen, wood, velvet, brass, gilded, silver, 1850



4. Kaub Tower, K. H., brass, silver plated, enamel, malachite, 1891
8. Coat belonging to King Ludwig II as Grand Master of the dynastic Order of Saint George, silk velvet, silver leaf, ermine, Order of the Knights of Saint George, Munich

Exhibition tour

A walk-through family tree provides an introduction to the history of the Wittelsbachs, one of the oldest dynasties in Europe. The exhibition focuses on the builders of the royal palaces Hohenschwangau and Neuschwanstein, King Maximilian II and his son, Ludwig II. How have they continued to shape this place, with its inhabitants, and the surrounding landscape? What importance is assigned to historical cycles and medieval legends in the castles' features? What plans did Ludwig II have for this area which he never managed to see through? With spectacular installations and using original exhibits, these questions are addressed in an exciting, informative and lively way. Another chapter demonstrates the tensions between representation of the Bavarian monarchy and the social, political and technological changes in the so-called industrial age. The third section of the exhibition tells of the end of the monarchy and the history of the Wittelsbach dynasty up until the present.

The exhibition is characterised by views of the surrounding landscape and the castles as well as by subtle use of cutting-edge, interactive museum technology and expansive installations, which explain the original exhibits in an informative, lively manner. In the lake-side part of the museum, visitors can dine like royalty in the museum café and restaurant, Alpenrose am See, whilst taking in the beauty of the magnificent mountain scenery and the views across the Alpsee.

The museum offers tours of varying depths. Guided tours and an audio guide in eight languages, children's tours and programmes for school classes are also on offer.

10. Crown Prince Rupprecht in tails with the sash and star of the Order of Saint Hubert, Max Rimboeck, oil on canvas, 1933
11. Three generations of the House of Wittelsbach: Prince Franz, Crown Prince Rupprecht, Prince Albrecht, 1954, Photo: Meta Köhler



MUSEUM OF THE BAVARIAN KINGS

Museum of the Bavarian Kings
 Alpseestrasse 27
 87645 Hohenschwangau
 Telefon +49 (0)8362 9 26 46 40
 info@museum-hohenschwangau.de
 www.museumderbayerischenkoenige.de

Opening hours between 01.04 and 30.09.:
 daily from 9 a.m. to 7 p.m.

Opening hours between 01.10. and 31.03.:
 daily from 10 a.m. to 6 p.m.

Admission fee:
 Adults: € 9.50
 Concessions: € 8
 Children up to twelve years of age are
 admitted free of charge

Swan Ticket
 Hohenschwangau Castle,
 Neuschwanstein Castle and museum:
 € 29,50, concessions € 28

Wittelsbach Ticket
 Hohenschwangau Castle and museum:
 € 20,50, concessions € 18



Legal notice
 Unless otherwise stated, the exhibits
 illustrated belong to the Wittelsbacher
 Ausgleichsfonds
 © Marcus Ebener and Rainer Herrmann



1.
*The Wittelsbach Family:
One House, Many Lines*

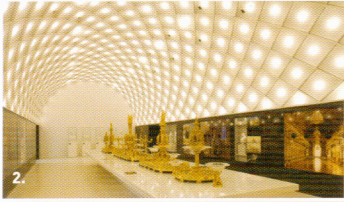

2.
*Maximilian II and Ludwig II:
Two Kings and History*

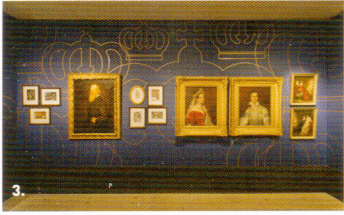

3.
*The Wittelsbachs: Kings in the
Constitutional State*
3.1
*The Wittelsbachs: Promoters of
Art and Culture*



3.2
The Wittelsbachs' Artistic Kingdom

3.3
Royal Builders

3.4
*Maximilian II and Ludwig II:
Two Kings in the Technological Age*



3.5
*Monarchy and Society in the 19th
Century*



3.6
The Legendary Ludwig II

1st Floor

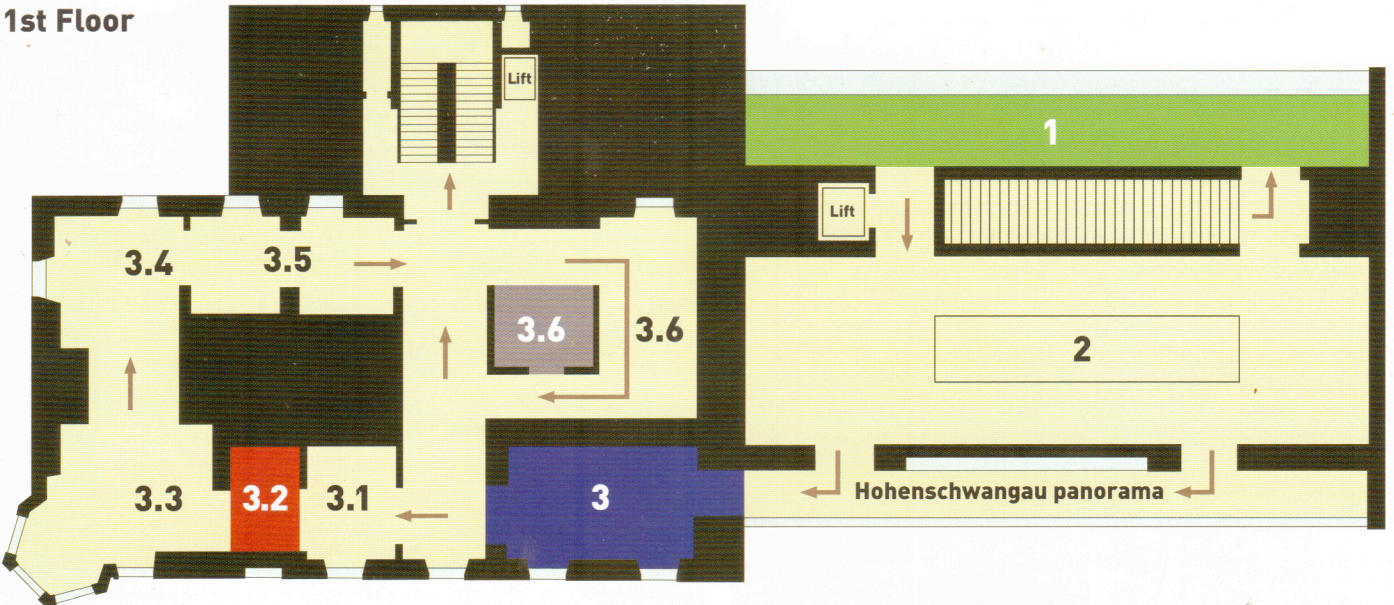

Ground Floor

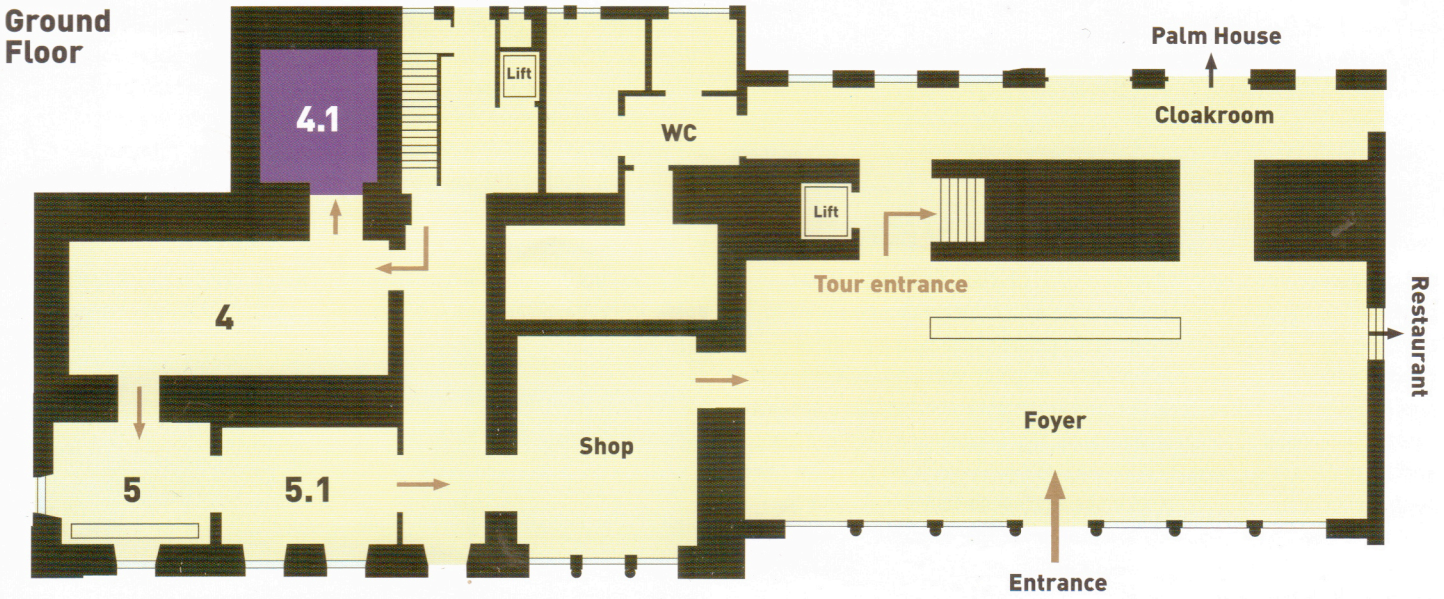

4.
*The Wittelsbachs in the
20th Century*



4.1
*The Golden Wedding
Anniversary of the Last
Bavarian Royal Couple*



5
*The Wittelsbachs in the Free
State of Bavaria after 1945*

5.1
Bavaria and the Wittelsbachs



Museum Shop